



### Seoul Office

SILVER Elevator Korea  
49, Bongeunsa-ro 22-gil, Gangnam-gu, Seoul, 06127, Korea  
Tel:+82\_2\_3275\_2065 Fax : +82\_2\_368\_1199

### Factory

SILVER Elevator Korea  
75, Gongdandong 4-gil, Chilseo-myeon, Haman-gun, Gyeongsangnam-do, 52002, Korea  
Tel:+82\_55\_312\_3531,7 Fax : +82\_55\_368\_3630

All the information in this catalogue is only for reference.  
SILVER Elevator Korea reserves the right to alter product design and specification without prior notice.  
Copyright © 2019 SILVER Elevator Korea  
www.silverelkorea.com

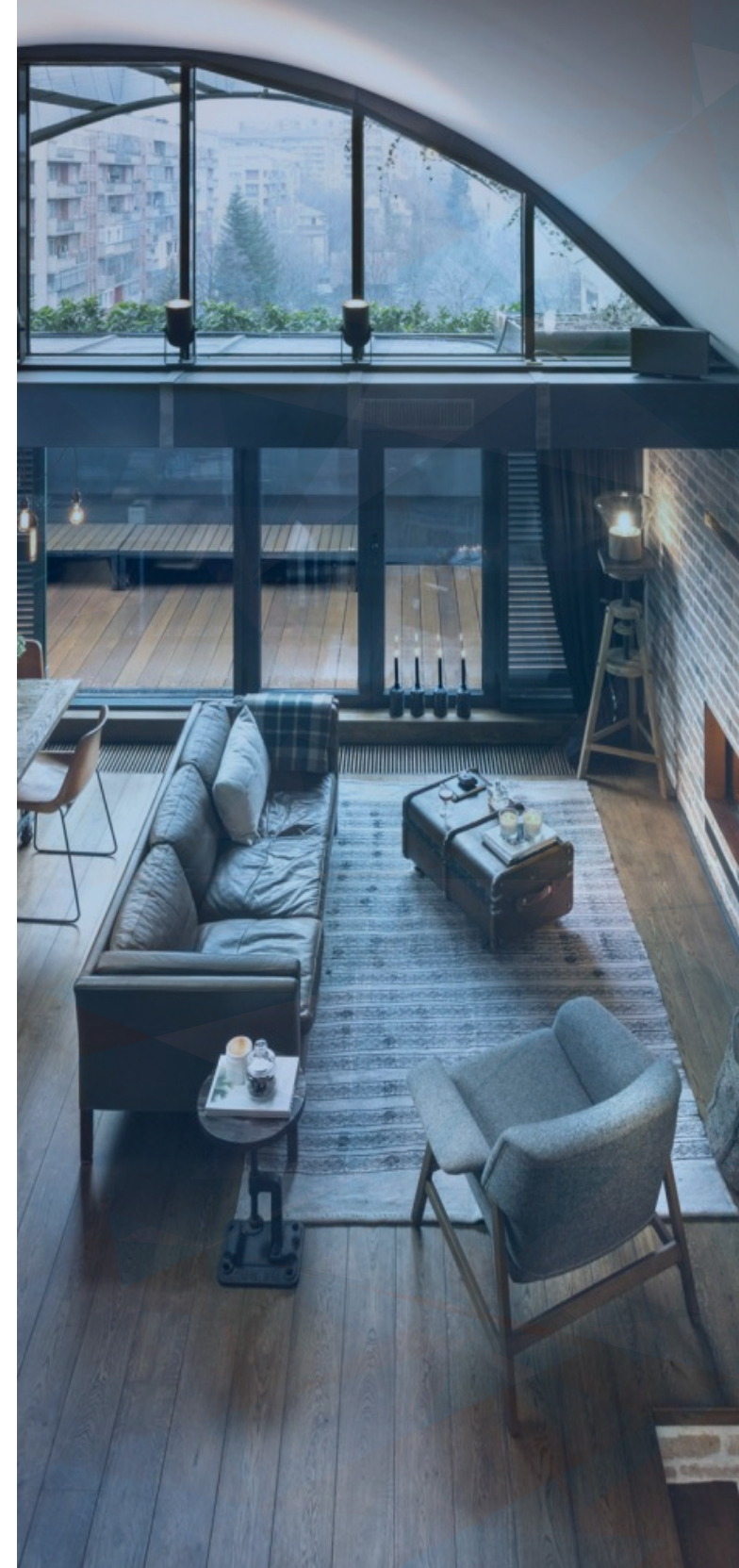

**SILVER**  
EXPRESS

# HOME ELEVATOR

**SILVER EXPRESS**  
ELEVATOR DESIGN



## 八种结构家用电梯 Eight kinds Home Elevator

### 龙门架结构家用电梯 Portal Frame Structure Home Elevator

曳引龙门架式家用电梯是靠对重牵引着轿厢做往返运动，运行起来非常平稳。电机完全是靠变频变压来调节速度，比较安静。

The Traction portal frame type home elevator is depending on CTW drag car with stable running. Motor complete depend on VVVF adjust speed, and it's quieter.



### 背包架结构家用电梯 Backpack Structure Home Elevator

背包架结构家用电梯主要针对比较窄而且相对比较深的井道，这种结构的家用电梯也是90°角双轿门电梯的良好选择。

Backpack structure home elevator mainly aimed for narrower but deeper shaft, and it's good choice for 90° right-angle two doors elevator.



### 钢带型家用电梯 Steel Belt Type Home Elevator

默纳克家用电梯采用更加节能，环保，耐用的复合钢带。质量轻，对井道支撑要求低；顶层高度要求低、驱动轮的直径大大减小；曳引机体积小，空间占用少。

MNK Home Elevator use more energy-saving, environmental and durable compose steel belt. Lightweight, less required of shaft bracket; Overhead required less, driver wheel diameter is decreased. Traction machine size is smaller, occupied less space.

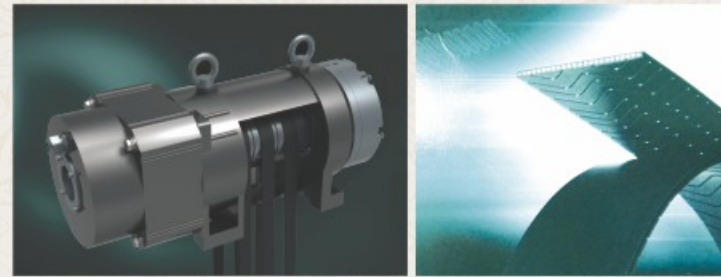

与传统钢丝绳相比：  
Compare with traditional steel rope:

- 绳股作了重新排布，扁平设计使接触面积增大，提高曳引摩擦力
- 聚氨酯包层既能保护钢丝绳股，又能增加柔韧性，减小曳引轮磨损
- 钢带不需要额外润滑，无油渍污染
- 比钢丝绳振动幅度低，更平稳舒适
- 比传统钢丝绳轻，节省电能
- 使用寿命比传统钢丝绳长

- Rope strand make with new arrangement, flat design make big connect area, increase traction friction force.
- Polyurethane cladding could protect steel rope strand also can increase flexibility, reduce traction wheel abrasion
- Steel rope no need extra lubrication, no oil stain contaminated
- Lower vibration than steel rope type, more smooth and comfortable
- Lighter than steel rope, save electricity
- Longer service life that traditional steel rope

### 液压式家用电梯 Hydraulic Home Elevator

- 机房设置灵活、井道利用率高、井道结构强度低。
- 运行平稳、乘坐舒适。液压系统传递动力均匀平稳，且比例阀能实现无级调速，电梯运行速度曲线变化平缓。
- 安全性好、可靠性高、噪声低、易于维修。

- Machine room position is flexible, shaft with high usage and low strength shaft structure.
- Stable running, comfortable for use. Hydraulic system deliver power with stable and proportional can achieve stepless speed regulation, Elevator running with lower curve change.
- Good security, High reliability, lower noise, easy for maintenance.





## 螺杆式家用电梯 Screw Type Home Elevator

螺杆式家用电梯沿着一根从顶到低的螺杆在封闭式的井框内做运动，没有对重，没有钢丝绳，螺杆式家用电梯结构合理，不容易发生故障。

Screw Type Home Elevator running with one screw from top to bottom in the shaft, without counterweight, without steel rope, screw type home elevator with rational construction, without break down.



## 别墅升降平台 Villa Platform

别墅电梯升降平台主要是针对家庭用户而设计，可无需专用电梯井道，噪音小，安装方便，安全可靠，是复式和多层居家理想的家用电梯，也是老人、残疾人居家最理想的上下交通工具。

Villa platform mainly design for home user, no need especially shaft, lower noise, easy for installation, safety and reliability, it's one of home elevator good for complex and multistory villa also it's the most ideal transportation for elders and disable people.



## 强制式驱动家用电梯 Positive Driver Home Elevator

强制式驱动家用电梯驱动方式为强制驱动，节省井道空间，轿厢空间能更大。

Positive driver home elevator use positive type driver motor, could save shaft space and make bigger cabin space.



## 座椅式家用电梯 Stair Lift

座椅式家用电梯依靠安装于楼梯左边或者右侧面的轨道运行，不破坏家庭的任何设施。采用钢制结构，铝合金铸件及阻燃塑壳组合而成，性能安全可靠。

Stair lift driven by the track installed on left or right side of the stairs, destroys no home facilities. Use steel structure, aluminum alloy castings parts and inflaming retarding plastic housing overall, more safety and reliability.







精品别墅电梯制造商

# 定制化设计满足多样化建筑结构

*High Quality Home Elevator manufacturer  
Customized design meets diversified architectural structures*

默纳克以专业设计团队为客户提供定制化布置方案服务，考虑到多种建筑空间场景条件下，为您设计最合理的安装布置方案，保障即使很小空间也能享受默纳克别墅电梯带来的尊贵服务。

MNK have professional design team provides customized service proposal for customers. Consider of varieties type constructions, offer you with reasonable arrangement. Even in small space also can enjoy VIP service from MNK Elevator.

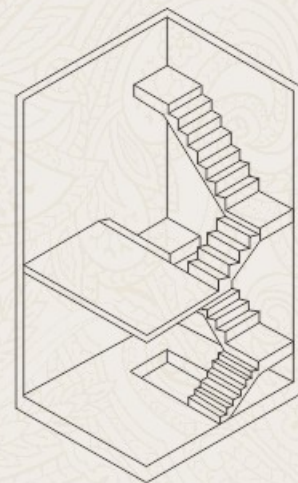

靠近楼梯周围有适当空间  
Have proper space around staircase

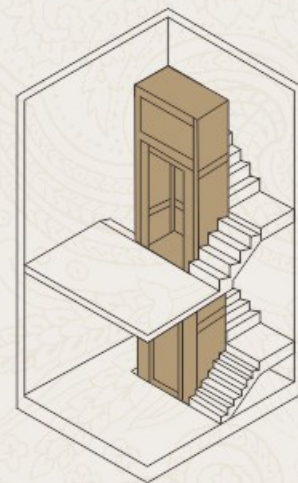

可在周围适当位置安装电梯  
Could install elevator round the proper area

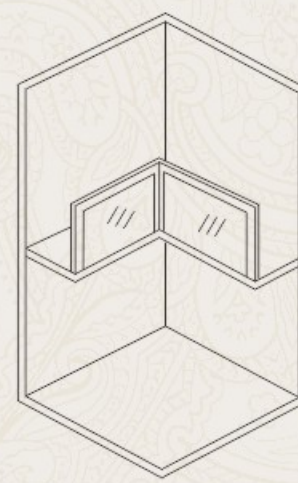

客厅或房间有中空位置  
Living room or bedroom have hollow position

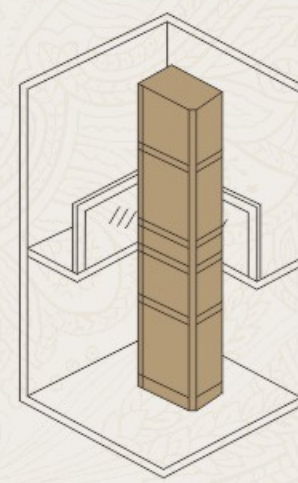

可加装井道安装电梯  
Could make shaft to install elevator

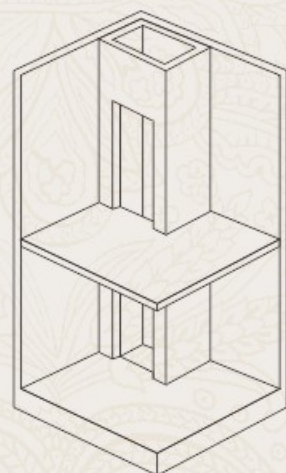

建筑预留专用井道  
Construction reserved shaft

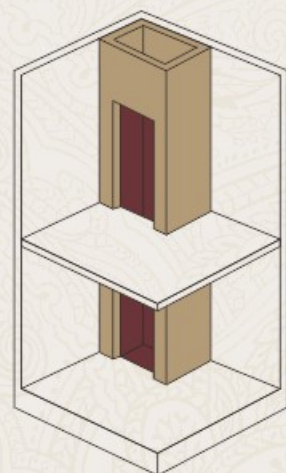

别墅电梯可直接安装在预留井道内  
Home Elevator could install in reserved shaft

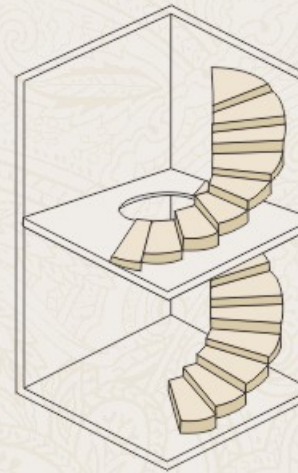

螺旋形楼梯有适当空间  
The spiral staircase has proper space

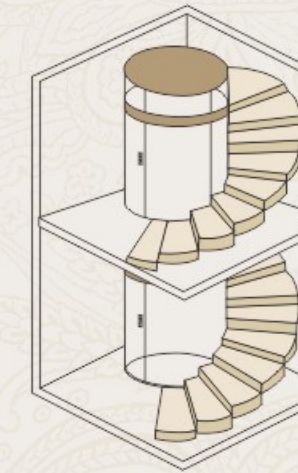

可在螺旋形的空间内安装全圆形电梯  
A full circular elevator can be installed in a spiral staircase space



室内没有合适位置  
Indoor haven't proper position

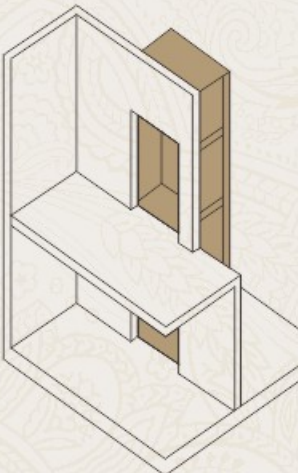

在室外加装井道安装电梯  
Install elevator in outdoor



## 绿色生活依花香 赋予别墅低碳生活环境

*Green life based on the fragrance of a flower Low carbon life from the application of multiple energy saving technology*

以精打细算的性格，节约每一分能源；以时尚奢华的外观，高效运行每一秒。  
绿色低碳生活，MNK在行动。

Budget strictly to save every energy, With fashionable and luxurious appearance, running with efficient operating in every second green low carbon life, MNK is doing.

### 高效节能曳引机

Efficient operate and energy saving traction machine

当设置在指定楼层的钥匙开关动作后，电梯将在应答完所有指令后返回指定楼层，同时将启动节能模式，切断轿内照明并点亮外停梯开关指示灯。

Use advanced electromagnetism proposal design and structural design, make motor delicate and compact, tightly structure, more excellent performance, effective save building area, save 30% energy than traditional traction machine.



### 节能停梯开关模式

Energy saving of stop elevator ON-OFF model

运用先进的电磁方案设计和结构设计，使主机精致小巧，结构紧凑，性能更为优异，有效节省建筑空间，比传统曳引机节能30%。

When setting designed floor with key On-Off action, Elevator will return to designed floor after response to all instructions. Meantime will start energy saving model, cut off car light and stop elevator switch indicator will be on.



### LED照明

LED Lighting

轿顶照明、井道照明、底坑照明均采用LED灯，比传统照明效率高出80%，照明时长是日光灯的10倍，同时无光照污染，无汞环保，绿色可回收。

Car top lighting, shaft lighting, pit lighting all use LED light, efficiency higher 80% than traditional light, LED light life is 10 times than fluorescent light, Meantime no light pollution, no mercury environmental protection, green recyclable.



### 环保锂电池

Environmental lithium battery

轿顶应急电源采用锂电池，寿命长，重量轻，污染小；相比较铅酸蓄电池，锂电池所使用的材料里不含有污染性金属、有害重金属物质。

Car top emergency power supply use lithium battery, longer life, light weight, lower pollution. Compare with acid storage battery, lithium batteries material does not contain pollution metals and harmful heavy metals.





## 安全无忧爱满堂 最懂家人安全的别墅电梯

*Safe and secure are full of love Security technology takes care of your family*

无论你是否同意，安全一直是电梯最大的问题，  
注重安全，建立高于行业标准的MNK安全标准，是MNK人的品质目标。

Whatever you agree or not, safe is the main problem always, pay attention for safety, MNK build higher safety standard than the elevator filed, always is quality goal in MNK.

### 门机系统

Door operator system

500万次可靠性运行验证，60多万台工地在用量，故障率极低。

500 million times reliability running test, more than 600 thousand sets under use, low failure rate.

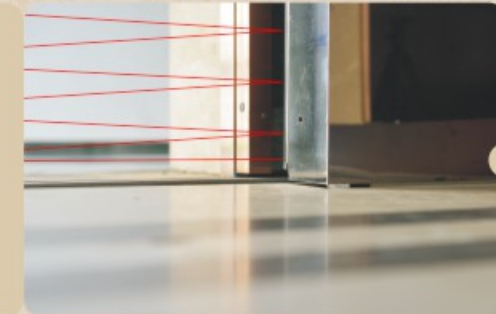

### 光幕和安全触板双重保护

Light curtain and safety edge double protection

光幕在电梯门口形成保护安全网，万一光幕失效还有安全触板进行第二重保护，双重保护安全性极高，进出自如。

Light curtain as protection safety network in front of elevator entrance, if light curtain failed also have safety edge as second protection, double protection with higher safety guard, come and out as your please.

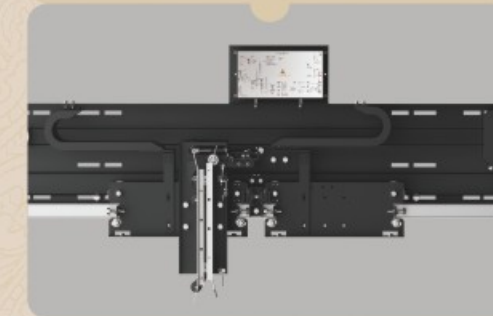

### 控制系统

Control system

出厂前经过100多项严格测试，产品故障率低于0.3%均通过严格的环境、电子、机械及EMC测试。

Before sell, more than 100 strictly test then send to customer, our elevator through strictly electrical and mechanical environment and EMC test, failure rate less than 0.3%.

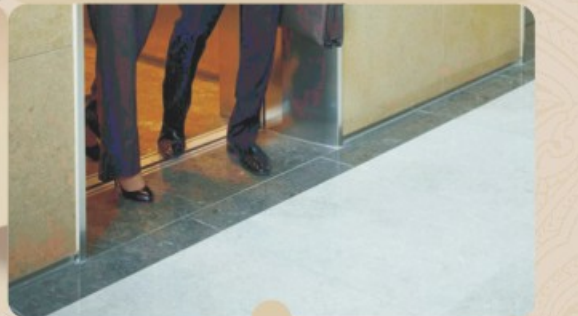

### 停电应急疏散装置

Automatic Rescuer Device

在电梯突然断电的情况下，不间断电源(UPS)延时数秒后UPS启动供电到控制柜，电梯就近平层后开门放人。

In the case of elevator suddenly interrupt situation, automatic rescuer device will supply power to control cabinet after a few seconds that elevator could land in near floor and open the door automatically.





## 岁月静好雅无声 享受生活的宁静与自然

*Life is quiet and elegant Enjoy quiet and natural of life*

生活的品质不在于喧闹的浮华，而在于心境的提升和格调的升华，以简驭繁的外观，超宁静运行，带给你一个宁静的居家享受。

Life's quality not in noised flashy but depend on improvement state of mind and sublimation of literary style. from simply to numerous appearance, super quiet running, give you a quiet enjoyment.

### 有效降噪5-10dB

Effective noise reduction 5-10dB

该系列主机运用先进的电磁方案设计和结构设计，使主机精致小巧，结构紧凑，性能更为优异，有效节省建筑空间。超静音制动器有效降噪5-10dB，制动力超进口同类产品。

Use advanced electromagnetism proposal design and structural design, make motor delicate and compact, tightly structure, more excellent performance, effective save building area, super quiet brake effective noise reduction 5-10dB, brake.



### 静音接触器

Quiet contactor

可配置滚轮导轨及静音接触器，让每一次骑行都“静”享美好。

Could use roller type guide shoe and quiet contactor, make every ride with quiet and enjoyment.



### 门机噪音仅50dB

Door operator noise 50dB

门机开门时间仅2s，噪音仅50dB，噪音低，不打扰大人和小孩睡眠，让家人舒睡每一晚。

Door open time only 2 seconds, the noise only 50dB. Lower noise will not disturb adults and children sleeping, make every night sleep with comfort.







## 标准配置

Standard configuration

### MNK-MS-M001

轿顶一体顶：镜面不锈钢框架 + 两边突出透光板 + 中间灯筒  
侧壁：发纹不锈钢 + 蚀刻不锈钢  
前壁：发纹不锈钢  
后壁：发纹不锈钢 + 镜面不锈钢  
地坪：耐磨型仿大理石 PVC

Car top in one piece: Mirror stainless steel frame + Light translucent plate on two sides + LED lamp in middle  
Side wall: Hairline stainless steel + mirror etching  
Front wall: Hairline stainless steel  
Rear wall: Hairline stainless steel + mirror  
Floor: PVC

### 操纵箱标配配置

Car operator panel standard configuration

显示：10.1 寸  
材质：发纹不锈钢  
Display: 4.3 inch  
Material: Hairline stainless steel



MNK-MS-C01

### 外召标配配置

LOP Standard configuration

显示：4.3寸LED  
液晶屏：4.3寸LED  
按钮：镜面不锈钢+亚克力 发白光  
材质：镜面不锈钢边框+亚克力面板  
Display: 4.3 inch LED  
LCD: 4.3 inch LED  
Button: BR36F, Mirror + black acrylic, white light  
Material: Mirror frame + black acrylic panel



MNK-MS-H01



### 壁挂式控制柜

Wall mounting type control cabinet

#### 至薄

薄至110mm、高度集成化壁挂式安装，既可安装在井道内也可壁挂在井道外。

#### 至静

静至48db、动态风扇运行、10hz载波  
标配：隔音盒+接触器 (52db)  
选配：无接触器方案 (48db)

Thin  
Thickness only 110mm, highly integration wall mounting type installation, could install inside of shaft, also install outer of shaft.

Quiet  
Stillness to 48dB, dynamic state operation, 10hz carrier wave  
Standard: Soundproof box + contactor (52dB)  
Optional: No contactor proposal (48dB)



### 轿顶一体箱

Car roof integrated box

#### 小体积，大能量

尺寸小，箱体薄，更适用于家用电梯紧张的轿顶空间。

#### 多功能安全照明灯

轿顶照明采用安全电压灯带照明；箱内作业区域亦设计有独立的安全照明。

#### 轿厢照明 / 风扇独立控制

照明、风扇由独立继电器控制，可通过操纵箱按钮启停轿厢照明及风扇，可免除操纵箱照明、风扇机械开关，让轿内更美观。

Small cubage, large energy  
Smaller size, thin box, thickness only 60mm, better for home elevator tight car roof space.

Multifunctional safety lighting  
Car roof lighting use safety voltage light-belt lamp. Box inter work area also designed with separated safety lighting.

Car lighting/Fan independent control  
Lighting, fan controlled by independent relay, thought COP button On/Off lighting and fan, no need mechanical switch for COP light and fan, make more good looking for car.

### 一体两用式控制柜

Dual purpose type control cabinet

#### 精致

超薄设计，一个体两用，可隐藏安装。

#### 静音

TUV 论证无接触器控制技术，使运行音量 < 45 分贝。

#### 舒适

卓越的家用梯驱动科技，为您创造最舒适美好的乘车体验。

#### 安全

拥有行业 SIL3 最高等级安全认证，融合多重防困人方案。

Exquisite  
Super thin design, dual purpose, could install in hide.

Quit  
TUV certificate no contactor control technology, make running noise < 45dB.

Comfort  
Outstanding home elevator driver technology create best comfort and nice ride experience for you.

Safety  
Have highest SIL3 safety certificate in elevator filed, Amalgamation multiple schemes of person-shutting.





## 人机界面 — 选配

Car operation panel — optional



MNK-MS-C02

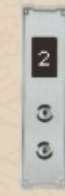

MNK-MS-H02



MNK-MS-C03



MNK-MS-H03



MNK-MS-C04



MNK-MS-H04



MNK-MS-C05



MNK-MS-H05



MNK-MS-C06



MNK-MS-H06



MNK-MS-C07

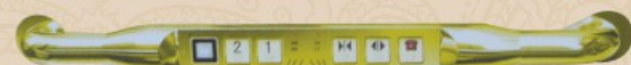

MNK-MS-C08

## 铝合金井道

Aluminum alloy structure

主要优势  
Main advantages



重量轻  
Light weight



便于安装  
Easy for installation



外形美观  
Beautiful appearance



无二次装修  
No second decoration

铝合金型材  
Aluminum alloy section



MNK-L001  
乳白色  
Milk white

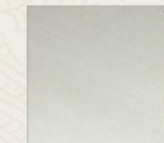

MNK-L002  
氧化本色  
Natural



MNK-L003  
土豪金色  
Gold



MNK-L004  
深咖啡色  
Dark coffee



MNK-L005  
红木色  
Red wood





# 轿厢装潢

Car decoration -- standard



**MNK-MS-1361**

吊顶：镜面不锈钢镀玫瑰金+透光云石+射灯  
后壁：镜面不锈钢镀玫瑰金+镜面不锈钢蚀刻镀玫瑰金  
侧壁：发纹不锈钢镀玫瑰金  
地坪：PVC  
扶手：镜面不锈钢圆管  
前壁：发纹不锈钢镀玫瑰金  
Ceiling: Rose gold mirror + Translucent dolomite + lamp  
Rear wall: Rose gold mirror + Rose gold mirror etching  
Side wall: Rose gold stainless steel  
Floor: PVC  
Handrail: Mirror stainless steel tube  
Front: Rose gold stainless steel



**MNK-MS-M002**

吊顶：香槟金镜面不锈钢边框+香槟金拉丝不锈钢+亚克力+暗藏灯+射灯  
后壁：香槟金镜面蚀刻不锈钢+香槟金镜面不锈钢  
侧壁：香槟金镜面蚀刻不锈钢+香槟金拉丝不锈钢  
地坪：蜂窝大理石拼花（奥特曼米黄+黑金花+爵士白+帝王金）  
前壁：香槟金长拉丝不锈钢  
Ceiling: Champagne gold mirror frame + Champagne gold stainless steel + acrylic + lamp  
Rear wall: Champagne gold mirror etched + champagne gold mirror stainless steel  
Side wall: Champagne gold mirror etched + champagne gold stainless steel  
Flooring: Honeycomb marble splice (Altman Beige + black gold + Jazz + imperial gold)  
Front wall: Champagne gold stainless steel



**MNK-MS-M003**

吊顶：古铜镜面不锈钢边框+古铜拉丝不锈钢+亚克力+暗藏灯+射灯  
后壁：古铜镜面蚀刻不锈钢+古铜拉丝不锈钢  
侧壁：古铜镜面蚀刻不锈钢+古铜拉丝不锈钢  
地坪：铜条镶嵌+黑金花+爵士白蜂窝大理石拼花  
前壁：古铜长拉丝不锈钢  
Ceiling: Copper mirror frame + copper stainless steel + acrylic + lamp  
Rear wall: Copper mirror etched stainless steel + copper stainless steel  
Side wall: Copper mirror etched stainless steel + copper stainless steel  
Baseboard: Copper stainless steel  
Flooring: Copper stripe inlay + black golden flower + white honeycomb marble  
Front wall: Copper long wire drawn stainless steel

# 蚀刻 Etching



**MNK-MS-M006**

吊顶：发纹不锈钢+筒灯  
轿壁：钢化玻璃  
地坪：PVC拼花  
Ceiling: Hairline stainless steel + Lamp  
Car wall: Round tempered glass  
Flooring: PVC



**MNK-MS-M007**

吊顶：镜面不锈钢框架+顶板LED灯  
轿壁：观光型+不锈钢+玻璃  
地坪：PVC拼花  
Ceiling: Mirror stainless steel frame + LED light  
Car wall: Tempered glass + stainless steel frame  
Flooring: PVC

# 观光轿厢



Sightseeing style



**MNK-MS-M1503**

吊顶：长发纹不锈钢镀玫瑰金+镜面不锈钢镀玫瑰金+亚克力  
轿壁：长发纹不锈钢镀玫瑰金+镜面不锈钢镀玫瑰金+夹胶玻璃  
前壁：长发纹不锈钢镀玫瑰金+夹胶玻璃  
地坪：拼花石材  
Ceiling: Rose gold stainless steel + Rose gold mirror + Acrylic  
Car wall: Temperate glass + Rose gold stainless steel frame  
Front wall: Temperate glass + Rose gold stainless steel frame  
Flooring: PVC



中式  
Chinese style



**MNK-MS-M008**

吊顶：烤漆木板框架+顶板+灯带  
后壁：木饰面开槽+蚀刻美容镜  
侧壁：木饰面开槽+侧壁上半部分两侧美容镜+水晶扣  
地坪：蜂窝大理石拼花（迪克米黄+金镶玉+绿玉石）  
前壁：玫瑰金镜面不锈钢

Ceiling: Painted wooden frame + LED light  
Rear wall: Veneer wooden panel + etching mirror  
Side wall: Veneer wooden panel + side wall upper part with mirror + crystal buckle  
Flooring: Marble  
Front wall: Rose gold mirror stainless steel  
Baseboard: Marble



**MNK-MS-CR106**

吊顶：烤漆钢板+透光云石+筒灯  
后壁：镜面不锈钢蚀刻玫瑰金  
侧壁：镜面不锈钢蚀刻玫瑰金+短发纹不锈钢玫瑰金  
地坪：PVC  
前壁：短发纹不锈钢玫瑰金

Ceiling: Painted steel panel + translucent dolomite + lamp  
Rear wall: Rose gold mirror etching  
Side wall: Rose gold stainless steel + mirror etching  
Flooring: PVC  
Front wall: Rose gold stainless steel



**MNK-MS-M009**

吊顶：造型烤漆木框+顶板+射灯、灯带  
后壁：造型烤漆木板+美容镜  
侧壁：造型烤漆木板+墙纸  
地坪：蜂窝大理石拼花（根据颜色选配）

Ceiling: Shaped veneer wooden + lamp light  
Rear wall: Shaped veneer wooden + mirror  
Side wall: Shaped veneer wooden + wallpaper  
Flooring: Marble



**MNK-MS-M010**

吊顶：木饰面+水晶灯  
轿壁：木饰面+墙纸+雕花饰品  
地坪：PVC拼花

Ceiling: Veneer wooden + crystal light  
Car wall: Veneer wooden + wallpaper + carved ornaments  
Flooring: PVC



**MNK-MS-1501**

吊顶：造型吊顶+上层贴银箔+LED暗藏灯  
后壁：烤漆木板+造型木线条+美容镜  
侧壁：烤漆木板+造型木线条  
地坪：石材拼花  
前壁：镜面不锈钢

Ceiling: Modelling ceiling + silver sticker + LED hiding light  
Rear wall: Painted wooden panel + modelling wood lines + mirror  
Side wall: Painted wooden panel + modelling wood lines  
Flooring: Stone pattern  
Front wall: Mirror stainless steel



**MNK-MS-1360**

轿吊一体顶：烤漆钢板（闪银钛金）+亚克力  
后壁：白色烤漆木板+烤漆木板线条（香槟金）+美容镜  
侧壁：白色烤漆木板+烤漆木板线条（香槟金）+美容镜  
地坪：PVC

Car & ceiling integrated: Painted steel panel (Titanium) + Acrylic  
Rear wall: White painted wooden + painted wooden lines (Champing gold) + Mirror  
Side wall: White painted wooden + painted wooden lines (Champing gold) + Mirror  
Flooring: PVC

欧式  
European style



木质  
Wooden



MNK-Z2107

吊顶：四周烤漆钢板+木线条+中间贴金箔+吸顶灯+LED灯带  
前壁：玫瑰金发纹不锈钢  
后壁：中间玫瑰金镜面蚀刻不锈钢+两边木纹板（胡桃木）+木线条  
侧壁：中间雕刻木纹板（胡桃木）+两边木纹板（胡桃木）+木线条  
扶手：两端玫瑰金镜面不锈钢+中间胡桃木  
地坪：大理石拼花（黑金花+帝皇金+黄玉石）

Ceiling: painted steel plate + wood line + gold foil + ceiling lamp + LED lamp belt  
Front wall: rose blonde stainless steel  
Back wall: middle rose gold mirror etched stainless steel + both sides wood grain board (walnut) + wood line  
Side wall: carved wood grain board (walnut) + both sides wood grain board (walnut) + wood line  
Handrail: rose gold mirror stainless steel at both ends + medium walnut  
Floor: marble Mosaic (black gold flower + emperor gold + topaz)

MNK-MS-M011

吊顶：木饰面+LED灯  
轿壁：木饰面+镜子  
地坪：PVC

Ceiling: Veneer wooden + LED lamp  
Car wall: Veneer wooden + mirror  
Flooring: PVC



MNK-MS-M012

吊顶：木饰面+LED灯  
轿壁：木饰面+镜子  
地坪：PVC

Ceiling: Veneer wooden + LED lamp  
Car wall: Veneer wooden + mirror  
Flooring: PVC





# 厅门选配

Capsules matching

## 手拉门

Manual door



MNK-MS-K001

MNK-MS-K002

MNK-MS-K003

## 自动门

Autom door



钛金蚀刻  
MNK-MS-T001  
( MNK-MS-002配套 )  
Titanium gold etching  
(For MNK-MS-002)

玫瑰金蚀刻  
MNK-MS-T002  
( MNK-MS-1361配套 )  
Rose gold etching  
(For MNK-MS-1361)

古铜蚀刻  
MNK-MS-T003  
( MNK-MS-093配套 )  
Copper etching  
(For MNK-MS-093)

黑钛镜面  
MNK-MS-T004  
Black titanium mirror



## 可选配置 Optional configuration

吊顶  
Ceiling

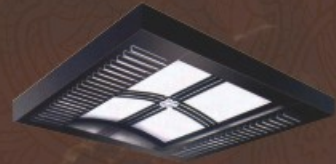

MNK-MS-D001

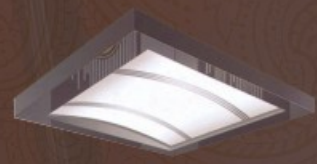

MNK-MS-D002



MNK-MS-D003



MNK-MS-D004

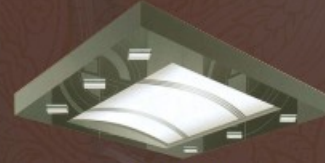

MNK-MS-D005



MNK-MS-D006

地坪  
Flooring



MNK-MS-P001



MNK-MS-P002



MNK-MS-P003



MNK-MS-P004

PVC

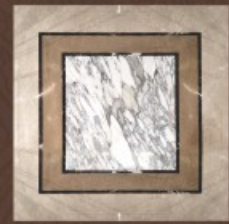

MNK-MS-P005



MNK-MS-P006

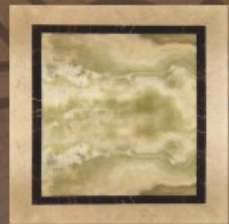

MNK-MS-P007



MNK-MS-P008

大理石  
Marble

扶手  
Handrail



MNK-MS-F001

镜面不锈钢圆管  
Mirror stainless steel tube



MNK-MS-F002

镜面不锈钢镀钛金圆管  
Titanium mirror stainless steel tube

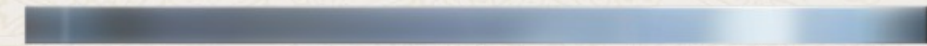

MNK-MS-F003

长发纹不锈钢  
Hairline stainless steel

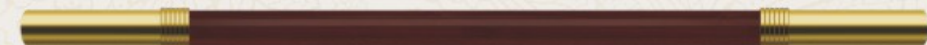

MNK-MS-F004

镜面不锈钢镀钛金圆管+实木  
Titanium mirror stainless steel tube + wooden



MNK-MS-F005

红古铜+花梨木  
Red copper + rosewood



# 电梯功能表

## Elevator function list



### 运行功能 Operation function

<b>井道位置自学习</b> Hoistway position self-learning	有井道位置自学习功能，并存储井道位置信号，当电梯正常运行时实现直接停靠。 It has the function of self-learning of the hoistway position and stores hoistway position signal. When the elevator is running normally, it can stop directly.	◆
<b>满载直驶</b> Full load with straight	当轿厢内载荷达到满载预设值时，即进入满载直驶状态，电梯将不再应答厅外召唤而直接响应轿内指令直达指定楼层。 When the load in the car reaches the preset value of full load, it will enter the state of full load and drive directly. The elevator will no longer answer the call outside the hall, but directly respond to the instructions in the car to the designated floor.	◆
<b>全集选</b> Full collective and selective	电梯对大楼内上、下召唤信号、轿内选层指令及各种信号进行综合分析判断后，将自动优选与电梯运行方向一致的信号进行依次应答。 After the elevator comprehensively analyzes and judges the signal of the up and down call signal, the instruction of selecting floor and all kinds of signals in the car, it will automatically select the signal that is consistent with the direction of the elevator running in order to respond.	◆
<b>反向指令自动消除</b> Reverse instruction is eliminated automatically	在向上或向下运行时，对于与当前运行方向相反的指令可自动消除。 When running up or down, instructions that run in the opposite direction from the current run are automatically eliminated.	◆
<b>重新初始化运行</b> Reinitialize the run	当电源因中断而恢复后，电梯位置信号未能保留或不能确定轿厢位置时，电梯将驶向端站重新定位。定位后位置显示器显示电梯所在的楼层位置，并恢复正常运行。 When the power supply is restored due to interruption, when the elevator position signal cannot be retained or the car position cannot be determined, the elevator will go to the terminal station and reposition. After positioning, the position indicator shows the floor position of the elevator and returns to normal operation.	◆
<b>开、关门按钮</b> Door open & close button	电梯轿厢操纵面板上设有控制开关门的微动按钮，以便乘客根据需要灵活掌握开关门的时间。 Car operator panel set with micro-button of control door open and close, convenient for passenger to control open and close door time flexible according to their needs.	◆
<b>错误指令取消</b> Error instruction cancel	当指令登记后，在电梯未起动前可通过连续点按此按钮以取消已登记的指令。电梯起动后，为保证乘客的人身安全，系统不允许取消已登记信号。 When the instruction is registered, the registered instruction can be cancelled by pressing this button continuously before the elevator is started. After the elevator starts, the system does not allow the cancellation of the registered signal in order to ensure the safety of passengers.	◆
<b>开、关门按钮灯</b> Open and close door button light	按下开、关门按钮的同时将点亮按钮灯以提示成功应答。 Press the "open" and "close" button while the button lights up to indicate a successful response.	◆
<b>本层厅外开门</b> Landing door open	在正常关门过程中，厅外与电梯同向的召唤按钮被按下时，电梯将重新开门。 In the normal closing process, when the call button outside the hall is pressed, the elevator will open again.	◆
<b>厅、轿门分别控制</b> Landing door and car door are respectively controlled	经过统计由厅外召唤引起的开门等待时间会比由轿内指令引起的开门等待时间要长，此功能通过独立调整电梯在响应召唤和指令时的开门保持时间，来提高整体的运行效率。 According to statistics, the waiting time of the door caused by the call outside the hall will be longer than the waiting time of the door caused by the instruction inside the car. This function can improve the overall operating efficiency by independently adjusting the door holding time of the elevator in response to the call and instruction.	◆
<b>关门等待取消</b> Close door and wait for cancellation	自动状态下，在门保持全开状态并且处于开门延时阶段时，按关门按钮可立即执行提前关门。 In the automatic state, when the door remains fully open and is in the opening delay stage, press the close button to immediately execute the early closing.	◆
<b>起动时力矩补偿</b> Starting moment of force compensation	为使电梯起动时获得更好的舒适感，系统对轿厢内载荷进行计算，并通过起动时的力矩补偿给予优化。 In order to get a better comfort when the elevator starts, the system calculates the load in the car and optimizes it through torque compensation when starting.	◆
<b>轿厢到站钟</b> Car arrival gong	电梯按照乘客的要求到达目的楼层后，从轿顶板发出提示信号。 When the elevator arrives at the destination floor as required by the passenger, it sends a signal from the roof of the car.	◇

<b>开门保持按钮</b> Door hold button	在进入轿厢乘客较多，需延长开门时间时，可按住操纵面板上的开门保持按钮。对于群控系统而言，当某一电梯进入开门保持状态时，系统会自动把分配给此梯的外呼信号转给其他电梯处理。 When there are more passengers entering the car and the opening time needs to be extended, you can press and hold the door holding button on the control panel. For group control system, when an elevator enters the open door and stays open, the system will automatically transmit the hall call signal assigned of this elevator to other elevators for processing.	◇
<b>厅外到站钟</b> Arrival gong for landing	安装于厅外的到站钟将在电梯到站前通知乘客准备进入轿厢。 The arrival gong installed outside the hall will inform passengers to prepare to enter the car before the elevator arrive.	◇
<b>下集选</b> Selective for down	电梯只在底楼或基站设有上行外呼按钮，其它楼层只有下行外呼按钮；电梯对大楼内的厅外召唤信号和轿内指令信号进行综合分析判断后，将自动优选与电梯运行方向一致的信号进行依次应答。 The elevator only has the up call button in the bottom floor or base station, other floors have the up and down call button. After the elevator comprehensively analyzes and judges the signal of the landing call and car, the signal that is consistent with the running direction of the elevator will be selected and answered in turn.	◇



### 应急功能 Emergency function

<b>轿厢内紧急照明</b> Emergency lighting in the car	在轿内设置的紧急照明装置，停电时启用。 The emergency lighting device installed in the car is activated when the power is off.	◆
<b>轿厢警铃</b> Car alarm	供在特殊情况下乘客通过按动轿厢内报警按钮，及时通知外界。 For passengers in special circumstances by pressing the car alarm button, timely inform the external world.	◆
<b>停电应急疏散装置</b> Power failure anAutomatic Rescuer Device (ARD)	当电梯正常运行中突然断电急停时，该装置会迅速动作，驱动电梯低速运行至平层位置，平层后开门。 When the elevator stops suddenly during normal operation, the device will act quickly and drive the elevator to run at a low speed to the landing floor position, which will open the door after landing.	◆



### 节能功能 Energy saving function

<b>停梯开关</b> Stop elevator switch	即驻停开关，当设置在指定楼层的钥匙开关动作后，电梯将在应答完所有指令后返回指定层楼，同时将启动节能模式，切断轿内照明并点亮厅外停梯开关指示灯。 The standing stop switch. When the key switch is set on the designated floor, the elevator will return to the designated floor after all instructions are answered. At the same time, the energy saving mode will be started, the car lighting will be cut off, and the indicator light of LOP will be turned on.	◇
-------------------------------------	--	---



### 监控功能 Monitoring function

<b>小区监测系统</b> Housing estate monitor system	小区监测系统是由微机在小区范围内实现对电梯进行全面监测的智能化管理系统，可为大楼智能管理提供数据（BA）。 The community monitoring system is an intelligent management system which realizes the comprehensive monitoring of elevators by microcomputer within the community, which can provide data for the intelligent management of buildings (BA).	◇
<b>楼宇电梯监视接口</b> Building elevator monitoring interface	电梯可以为用户的大楼智能管理系统提供离散型电梯运行状态信号，主要信号为：运行方向、楼层信息、安全信息等。 The elevator can provide users with discrete elevator running status signals for the intelligent management system of the building. The main signals are: running direction, floor information, safety information etc.	◇



 安全功能  
Safety features

<p><b>超载保护</b> Overload protection</p>	<p>当轿厢的载重量超出额定允许的载重时，超载蜂鸣器会鸣响以提示超载。此时显示超载，轿厢不关门，电梯不能起动。</p> <p>When the car load exceeds the allowable load, the overload buzzer will ring to indicate the overload. At this point, the display is overloaded, the car does not close, the elevator cannot start.</p>	◆
<p><b>驱动设备过热</b> Overheat of drive equipment</p>	<p>由于机房温度过高或运行发热，电动机温度超过预设值时，电梯将自动进入保护状态。电梯就近停靠，开门安全疏散乘客并关闭轿内照明和电扇，温度正常后，电梯恢复正常运行。</p> <p>When the motor temperature exceeds the preset value due to the high temperature of the machine room or the heating of the operation, the elevator will enter the protective state automatically. The elevator stopped nearby, opened the door to evacuate passengers safely and closed the car lighting and electric fans. After normal temperature, the elevator returned to normal operation.</p>	◆
<p><b>终端楼层保护</b> Terminal floor protection</p>	<p>当电梯运行到终端楼层时，运行速度没有减至预设值时，系统将强迫减速，保护电梯的安全运行。</p> <p>When the elevator runs to the terminal floor and the running speed is not reduced to the pre-set value, the system will force the deceleration to protect the safe operation of the elevator.</p>	◆
<p><b>内部通话装置</b> Intercom</p>	<p>用于在特殊情况下通过设置在轿厢操纵面板、轿顶上的对讲装置保持与机房及监控中心的语音联系。</p> <p>It is used to maintain voice communication with the machine room and the monitoring center through the intercom device set on the car control panel and the top of the car under special circumstances.</p>	◆
<p><b>故障自诊断</b> Fault self-diagnosis</p>	<p>当控制系统自动侦测到控制回路的异常时，自动停梯保障乘客的安全。</p> <p>When the control system automatically detects the abnormality of the control loop, will automatic stop elevator ensures the safety of passengers.</p>	◆
<p><b>轿厢开门保护</b> Car open protection</p>	<p>当电梯由于机械卡阻等原因导致不能开门到位超过预定时间时，内外呼信号会自动取消，驶向相邻层楼开门并释放乘客。</p> <p>When the elevator is unable to open the door beyond the scheduled time due to mechanical obstruction and other reasons, the internal and external call signal will be cancelled automatically, and the elevator will go to the adjacent floor to open the door and release passengers.</p>	◆
<p><b>轿厢关门保护</b> Car close protection</p>	<p>当电梯由于机械卡阻等原因导致不能关门到位超过预定时间，电梯重复三次关门后，未检测到门关闭信号，电梯会自动进入保护状态，当电梯监测到门已正常关闭时，电梯将恢复正常操作。</p> <p>When the elevator cannot close the door in place beyond the scheduled time due to mechanical obstruction and other reasons, the elevator repeatedly closes the door for three times without detecting the door closing signal, and the elevator will automatically enter the protective state. When the elevator detects that the door has been closed normally, the elevator will resume normal operation.</p>	◆
<p><b>关门力矩保护</b> Door close moment of force protection</p>	<p>当关门时受到反向阻力，超过预设的力矩值时，电梯将重新开门。</p> <p>When the door closes, the elevator will open again when the reverse resistance exceeds the preset torque value.</p>	◆
<p><b>轿厢关门延迟保护</b> Car close delay protection</p>	<p>当电梯开门时间由于外呼按钮被按住或其他因素而超过预定时间时，电梯会强迫关门来应答其他信号。当电梯强迫关门重复几次仍未关紧，电梯将停止运转并开门，内外呼信号会自动取消。当电梯监测到门已正常关闭时，电梯恢复正常操作。</p> <p>When the opening time of the elevator exceeds the scheduled time due to the holding of the outgoing call button or other factors, the elevator will force the door to close to respond to other signals. When the elevator forces the door to close several times and remains unclosed, the elevator will stop running and open the door. When the elevator detects that the door is normally closed, the elevator returns to normal operation.</p>	◆
<p><b>速度反馈检测功能</b> Speed feedback detection function</p>	<p>系统一旦检测到实际速度与给定速度不符，将自动断开安全回路并发出警报。</p> <p>Once the system detects that actual speed is not in accordance with the given speed, it will automatically disconnect the safety circuit and issue an alarm.</p>	◆
<p><b>接触器反馈检测功能</b> Contactor feedback detection function</p>	<p>无论电梯处于待机状态还是运行状态，系统将检测输出继电器的状态，一旦发现接触器处于非正常状态，系统将报警。</p> <p>Whether the elevator is in standby or running state, the system will detect the state of the output relay. Once the contactor is found to be in abnormal state, the system will alarm.</p>	◆

<p><b>抱闸反馈检测功能</b> Brake feedback detection function</p>	<p>对抱闸继电器信号进行全程监控，当发现抱闸继电器的实际状态与始定的命令不符时，停止运行。</p> <p>The signal of the lock relay is monitored throughout the whole process. When the actual state of the lock relay is found to be inconsistent with the original command, the operation is stopped.</p>	◆
<p><b>轿顶检修</b> Car roof overhaul</p>	<p>电梯轿顶设有检修箱，使检修维护更为安全快捷。</p> <p>There is an inspection box on the top of the car roof, which makes the maintenance safer and faster.</p>	◆

▼▲ 人机界面  
Car Operator Panel

<p><b>厅外及轿内方向指示</b> Directions outside the hall and inside the car</p>	<p>为方便乘客了解电梯的运行方向，在轿内操纵面板和厅外召唤面板上有箭头状指示灯提示运行方向。</p> <p>In order to facilitate passengers to know the direction of the elevator, there are arrow indicators on the car control panel and the outside call panel to indicate the direction of the elevator.</p>	◆
<p><b>语音报站</b> Voice announcer</p>	<p>电梯在减速平层过程中会用语音报出即将停靠的层站，提醒乘客注意。</p> <p>In the process of decelerating landing, the elevator will voice out the floor station that will stop soon, reminding passengers to pay attention.</p>	◇
<p><b>电梯专用空调</b> Elevator air-conditioning</p>	<p>专门针对轿厢内空气调节设计，为独立循环系统，通过冷凝水自动雾化、超水位自动切换工作模式及水位极限保护、空气净化等功能调节，使轿厢内的空气温度、湿度、洁净度和气流速度等参数保持在人体舒适的范围之内，营造轿内清凉空间。</p> <p>Specifically, for air conditioning design in cabin, circulating system for independence, automatically by the condensed water atomization, super water level automatic switch working mode and limit water level protection, air purification functions such as regulation, make the air temperature and humidity inside the cabin, the clean degree and air velocity within the range of parameters, such as in a human body comfort, build cool space in the car.</p>	◇
<p><b>轿内 LCD 显示</b> Car LCD display</p>	<p>利用液晶显示器作为高档轿内显示。</p> <p>Use liquid crystal display as high-grade car display.</p>	◇

 特殊运行  
Special operation

<p><b>光幕门保护</b> Light screen door protection</p>	<p>利用光幕装置发出的红外光线对进入其探测区域的任何物体进行扫描，形成一个敏感度高、安全性好的红外线屏。一旦光线受到干扰，电梯门就很快地重新开启而不会磁伤乘客，从而保证了乘客安全方便地进出电梯。</p> <p>The infrared ray emitted by the light curtain device is used to scan any object entering its detection area to form a sensitive and safe infrared screen. Once the light is disturbed, the doors are quickly reopened without injuring the passengers, thus making it safe and convenient for passengers to get in and out of the elevator.</p>	◆
<p><b>光眼与安全触板保护</b> Light eye and safety edge protection</p>	<p>利用反应可靠的机械式挡板和灵敏的红外光束的双重探测作用，为乘客出入轿厢提供安全保障。</p> <p>The double detection function of the reliable mechanical baffle and the sensitive infrared beam is used to provide safety guarantee for passengers to enter and leave the car.</p>	◇

注：◇ 为可选功能  
Marks: ◇ are optional functions





# 默纳克 家用梯土建图

MNK Home Lift Construction Layout Drawing

## 半圆强制驱动参数表

Semi-round positive drive parameter table

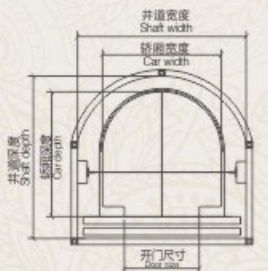

轿厢宽度 Car width	950	1150
轿厢深度 Car depth	1000	1200
井道宽度 Shaft width	1350	1550
井道深度 Shaft depth	1300	1500
开门尺寸 Door size	600	700
载重(kg) Load capacity	320	400
底坑≥500 Pit	顶层≥4000 OH	

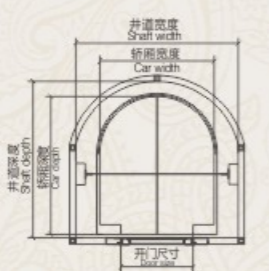

轿厢宽度 Car width	750	1000
轿厢深度 Car depth	950	1200
井道宽度 Shaft width	1100	1350
井道深度 Shaft depth	1100	1350
开门尺寸 Door size	700	800
载重(kg) Load capacity	320	400
底坑≥500 Pit	顶层≥4000 OH	

## 全圆强制驱动参数表

Round positive drive parameter table



轿厢直径 Cabin diameter	φ1130	φ1230
井道直径 Shaft diameter	φ1650	φ1800
开门尺寸 Door size	600	800
载重(kg) Load capacity	320	400
底坑≥500 Pit	顶层≥4000 OH	

## 土建侧对重参数表

Construction side CTW parameter table

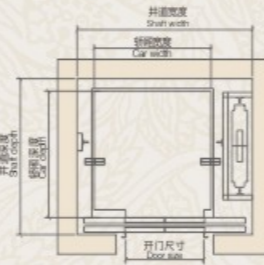

轿厢宽度 Car width	1000	1000	1100	1200
轿厢深度 Car depth	1000	1200	1400	1300
井道宽度 Shaft width	1600	1600	1700	1800
井道深度 Shaft depth	1250	1450	1650	1550
开门尺寸 Door size	700	700	750	800
载重(kg) Load capacity	320	320	400	400
底坑≥500 Pit	顶层≥2800 OH			

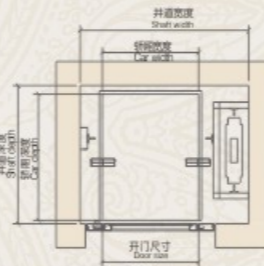

轿厢宽度 Car width	800	800	1000	1100
轿厢深度 Car depth	900	1100	1200	1300
井道宽度 Shaft width	1400	1400	1600	1700
井道深度 Shaft depth	1000	1200	1300	1400
开门尺寸 Door size	800	800	800	800
载重(kg) Load capacity	320	320	400	400
底坑≥500 Pit	顶层≥2800 OH			

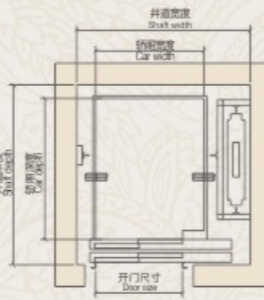

轿厢宽度 Car width	800	1000	1000	1100
轿厢深度 Car depth	1000	1200	1300	1400
井道宽度 Shaft width	1400	1600	1600	1700
井道深度 Shaft depth	1300	1500	1600	1700
开门尺寸 Door size	700	800	800	800
载重(kg) Load capacity	320	320	400	400
底坑≥500 Pit	顶层≥2800 OH			

## 铝合金侧对重参数表

Aluminum frame side CTW parameter table

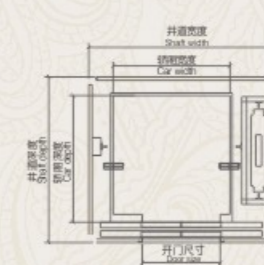

轿厢宽度 Car width	1000	1000	1100	1200
轿厢深度 Car depth	1000	1200	1400	1300
井道宽度 Shaft width	1700	1700	1800	1900
井道深度 Shaft depth	1350	1550	1750	1650
开门尺寸 Door size	700	700	750	800
载重(kg) Load capacity	320	320	400	400
底坑≥500 Pit	顶层≥2800 OH			

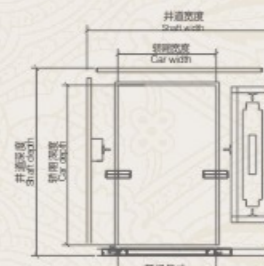

轿厢宽度 Car width	800	800	1000	1100
轿厢深度 Car depth	900	1100	1200	1300
井道宽度 Shaft width	1500	1500	1700	1800
井道深度 Shaft depth	1100	1300	1400	1500
开门尺寸 Door size	800	800	800	800
载重(kg) Load capacity	320	320	400	400
底坑≥500 Pit	顶层≥2800 OH			

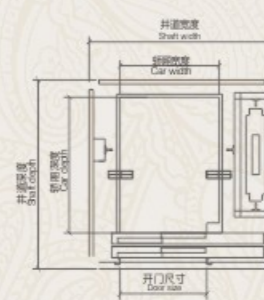

轿厢宽度 Car width	800	1000	1000	1100
轿厢深度 Car depth	1000	1200	1300	1400
井道宽度 Shaft width	1500	1700	1700	1800
井道深度 Shaft depth	1400	1600	1700	1800
开门尺寸 Door size	700	800	800	800
载重(kg) Load capacity	320	320	400	400
底坑≥500 Pit	顶层≥2800 OH			

注：底坑深度和顶层高度可根据现场调整  
Mark: Pit depth and overhead height could adjust according to locale.

注：底坑深度和顶层高度可根据现场调整  
Mark: Pit depth and overhead height could adjust according to locale.



土建后对重参数表  
Construction rear CTW parameter table

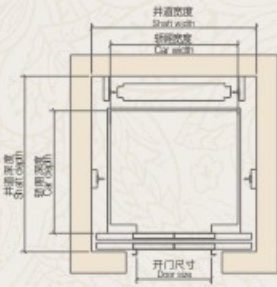

轿厢宽度 Car width	1100	1100	1400	1300
轿厢深度 Car depth	800	1000	1100	1200
井道宽度 Shaft width	1450	1450	1750	1650
井道深度 Shaft depth	1300	1500	1600	1700
开门尺寸 Door size	650	700	800	750
载重(kg) Load capacity	320	320	400	400
底坑≥500 Pit	顶层≥3500 OH			

铝合金后对重参数表  
Aluminum frame rear CTW parameter table

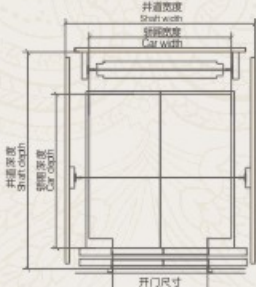

轿厢宽度 Car width	1100	1100	1400	1300
轿厢深度 Car depth	800	1000	1100	1200
井道宽度 Shaft width	1500	1500	1800	1700
井道深度 Shaft depth	1400	1600	1700	1800
开门尺寸 Door size	650	700	800	750
载重(kg) Load capacity	320	320	400	400
底坑≥500 Pit	顶层≥3500 OH			

土建强制驱动参数表  
Construction positive drive parameter table

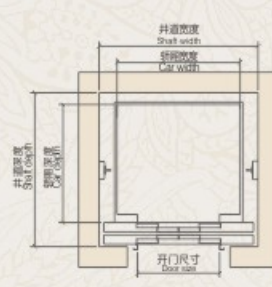

轿厢宽度 Car width	1000	1000	1000	1200
轿厢深度 Car depth	800	1000	1200	1000
井道宽度 Shaft width	1350	1350	1350	1550
井道深度 Shaft depth	1150	1350	1550	1350
开门尺寸 Door size	750	750	750	800
载重(kg) Load capacity	320	320	400	400
底坑≥500 Pit	顶层≥3500 OH			

铝合金强制驱动参数表  
Aluminum frame positive drive parameter table

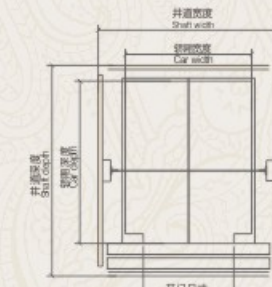

轿厢宽度 Car width	1000	1000	1000	1200
轿厢深度 Car depth	800	1000	1200	1000
井道宽度 Shaft width	1400	1400	1400	1600
井道深度 Shaft depth	1250	1450	1650	1450
开门尺寸 Door size	750	750	750	800
载重(kg) Load capacity	320	320	400	400
底坑≥500 Pit	顶层≥3500 OH			

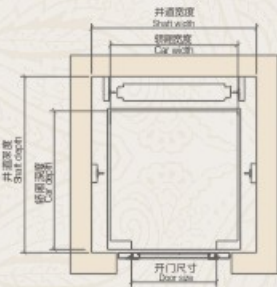

轿厢宽度 Car width	800	1000	1000	1200
轿厢深度 Car depth	800	1000	1200	1000
井道宽度 Shaft width	1150	1350	1350	1550
井道深度 Shaft depth	1150	1350	1550	1350
开门尺寸 Door size	800	800	800	800
载重(kg) Load capacity	320	320	400	400
底坑≥500 Pit	顶层≥3500 OH			

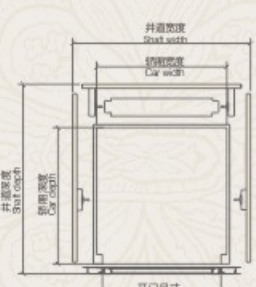

轿厢宽度 Car width	800	1000	1000	1200
轿厢深度 Car depth	800	1000	1200	1000
井道宽度 Shaft width	1200	1400	1400	1600
井道深度 Shaft depth	1250	1450	1650	1450
开门尺寸 Door size	750	800	800	800
载重(kg) Load capacity	320	320	400	400
底坑≥500 Pit	顶层≥3500 OH			

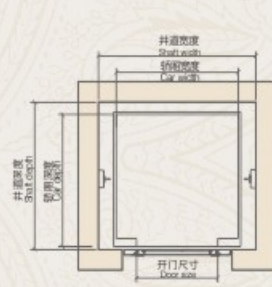

轿厢宽度 Car width	800	800	1000	1200
轿厢深度 Car depth	800	1000	1200	1000
井道宽度 Shaft width	1150	1150	1350	1550
井道深度 Shaft depth	950	1150	1350	1150
开门尺寸 Door size	800	800	800	800
载重(kg) Load capacity	320	320	400	400
底坑≥500 Pit	顶层≥3500 OH			

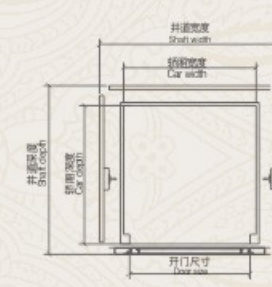

轿厢宽度 Car width	800	800	1000	1200
轿厢深度 Car depth	800	1000	1200	1000
井道宽度 Shaft width	1200	1200	1400	1600
井道深度 Shaft depth	1050	1250	1450	1250
开门尺寸 Door size	750	750	800	800
载重(kg) Load capacity	320	320	400	400
底坑≥500 Pit	顶层≥3500 OH			

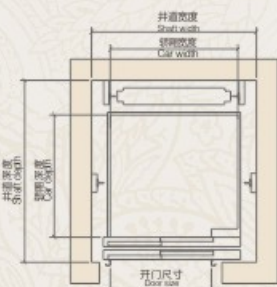

轿厢宽度 Car width	1000	1000	1300	1200
轿厢深度 Car depth	800	1000	1200	1300
井道宽度 Shaft width	1350	1350	1650	1550
井道深度 Shaft depth	1350	1550	1750	1850
开门尺寸 Door size	700	700	800	800
载重(kg) Load capacity	320	320	400	400
底坑≥500 Pit	顶层≥3500 OH			

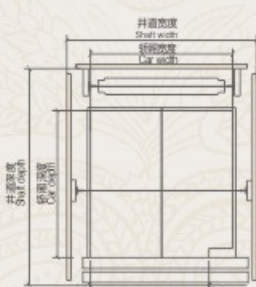

轿厢宽度 Car width	1000	1000	1300	1200
轿厢深度 Car depth	800	1000	1200	1300
井道宽度 Shaft width	1400	1400	1700	1600
井道深度 Shaft depth	1450	1650	1850	1950
开门尺寸 Door size	700	700	800	800
载重(kg) Load capacity	320	320	400	400
底坑≥500 Pit	顶层≥3500 OH			

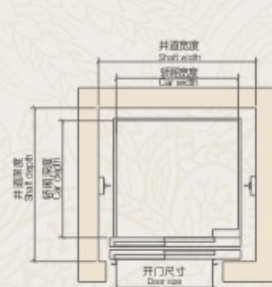

轿厢宽度 Car width	1000	1000	1000	1200
轿厢深度 Car depth	800	1000	1200	1000
井道宽度 Shaft width	1350	1350	1350	1550
井道深度 Shaft depth	1150	1350	1550	1350
开门尺寸 Door size	750	750	750	800
载重(kg) Load capacity	320	320	400	400
底坑≥500 Pit	顶层≥3500 OH			

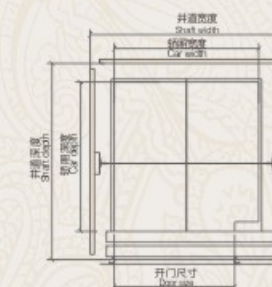

轿厢宽度 Car width	1000	1000	1000	1200
轿厢深度 Car depth	800	1000	1200	1000
井道宽度 Shaft width	1400	1400	1400	1600
井道深度 Shaft depth	1250	1450	1650	1450
开门尺寸 Door size	750	750	750	800
载重(kg) Load capacity	320	320	400	400
底坑≥500 Pit	顶层≥3500 OH			

注：底坑深度和顶层高度可根据现场调整  
Mark: Pit depth and overhead height could adjust according to locale.

注：底坑深度和顶层高度可根据现场调整  
Mark: Pit depth and overhead height could adjust according to locale.



# 默纳克电梯 物联网系统

MNK elevator Internet of things system



## 电梯物联网功能

Elevator Internet of things function



## 系统功能展示

System function display



默纳克电梯物联网系统  
MNK Elevator internet of things system

## 电梯物联网架构

Elevator Internet of things architecture

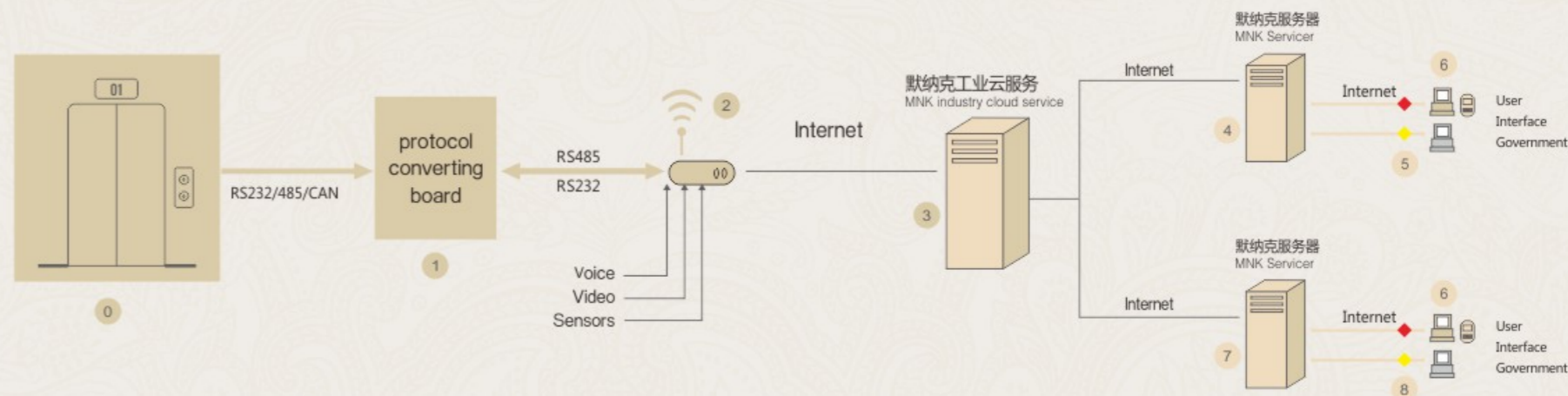



### 高端私人定制

High-end private customize

根据您的要求，为您量身定制属于您的专属电梯

According to your requirements, customize exclusive elevator belongs to you.



### 顶层高度要求小

Lower OH requirement

标准门-顶层高度最小要求2.8m，半高门-无顶层高度限制

Standard door- Min OH height only 2.8 meter Half height door- No OH height limited



### 大容量备用电源

Large capacity spare power supply

采用蓄电池作为备用电源，断电后可应急上下运行

Use storage battery as spare power, emergency running up and down after power failure.



### 无需井道

No need shaft

铝合金观光和封闭式钢板型材不但提高井道利用率，电梯的结构美观又牢固

Aluminum alloy sightseeing and closed steel plate profile not only improve the utilization rate of well way, but also enhance the structure of elevator



### 智能化控制

Intelligent control

结合当代工控和通讯技术的控制技术远程监控，对电梯运行状况全程掌控

Combined with remote monitor of control technology for modern industrial and communication technology, elevator operation is in full control.



### 最小可定制1000x900mm的别墅梯

Minimum could customize 1000\*900 Home Elevator

预留尺寸仅需1000X900mm，占地空间小，内部空间利用率高达69.5%

Reserved size only 1000\*900mm, takes smaller space, the utilization of internal space up to 69.5%.



### 产品选择多样

Variety of product selection

涵盖曳引式、强制式、液压式、钢带式、链条式多种开门方式，自动门、手动门、圆弧门等

Covered with traction, positive drive, Hydraulic, steel belt, chain type etc. door open type with auto door, manual door, round door etc. types.



### 安装周期短

Short installation period

2-5层电梯安装周期仅需7天左右

2-5 floors home elevator installation period need only 7 days



### 全过程保姆式服务

Whole process housekeeper service

配备经验丰富的专业技术团队，提供售前、售中、售后三个阶段的技术指导状况全程掌控

We have experienced professional team, provide pre-sale, on-sale, after-sale, three stages of technical guidance throughout the situation.

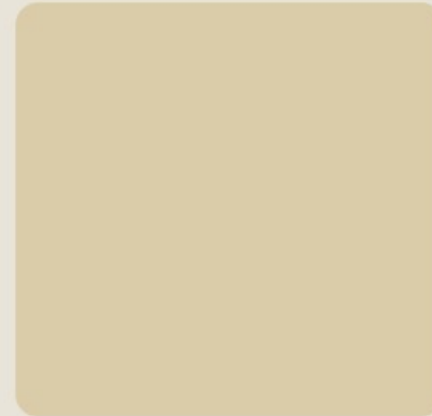

### "0"底坑设计,无需切楼板

"0" pit design and no need cut floor slab

无底坑设计，电梯可直接放置在地面上底坑最小要求仅10厘米

No bottom pit design, the elevator can be placed directly on the ground bottom pit minimum requirements only 10 cm